



India Basin Shoreline Park Arts Enrichment Pre-Application Workshop

Pre-Application Workshop – 27 September 2022 @ Bayview Opera House
4 October 2022 @ Zoom Virtual Meeting

Omar Davis
Project Manager, San Francisco Recreation & Parks Department

Ariane Gelardin Davidian
Project Manager, San Francisco Arts Commission

Craig Corpora
Program Associate, San Francisco Arts Commission



An aerial architectural rendering of a waterfront park. The scene shows a paved walkway with people, a grassy area, a colorful mural on a wall, and a playground. In the background, there's a body of water with a pier and cranes. A dark blue rectangular box is overlaid on the center of the image, containing white text.

Land Acknowledgement

The San Francisco Arts Commission acknowledges that we are on the unceded ancestral homeland of the Ramaytush Ohlone. We affirm the sovereign rights of their community as First Peoples and are committed to supporting the traditional and contemporary evolution of the American Indian community and uplifting contemporary indigenous voices and culture.

An aerial architectural rendering of a waterfront park. The scene shows a paved walkway with people walking and sitting on benches. There are various trees, including some with red trunks, and landscaped areas with colorful plants. In the background, a large body of water is visible, with a pier and several cranes on the left side. A dark blue rectangular overlay is positioned in the center of the image, containing the title and a list of agenda items in white text.

Today's Agenda

- Welcome & Introductions
- India Basin Shoreline Park Project Background (RPD)
- Art Enrichment Opportunity Details & Artist Selection Process (SFAC)
- Technical Workshop for Applying (SFAC)
- Q&A

THE LOCATION

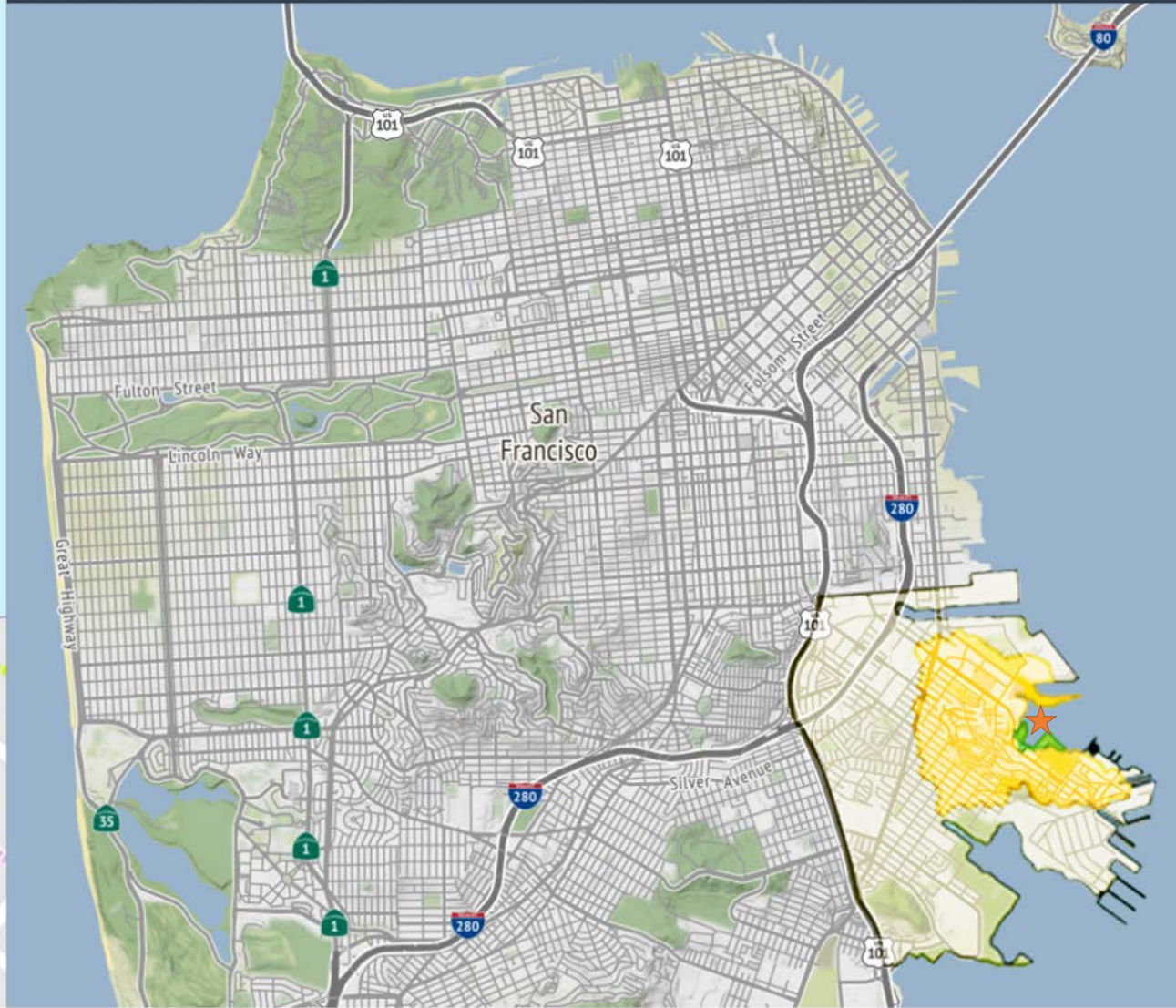

HIGHLIGHT FEATURES

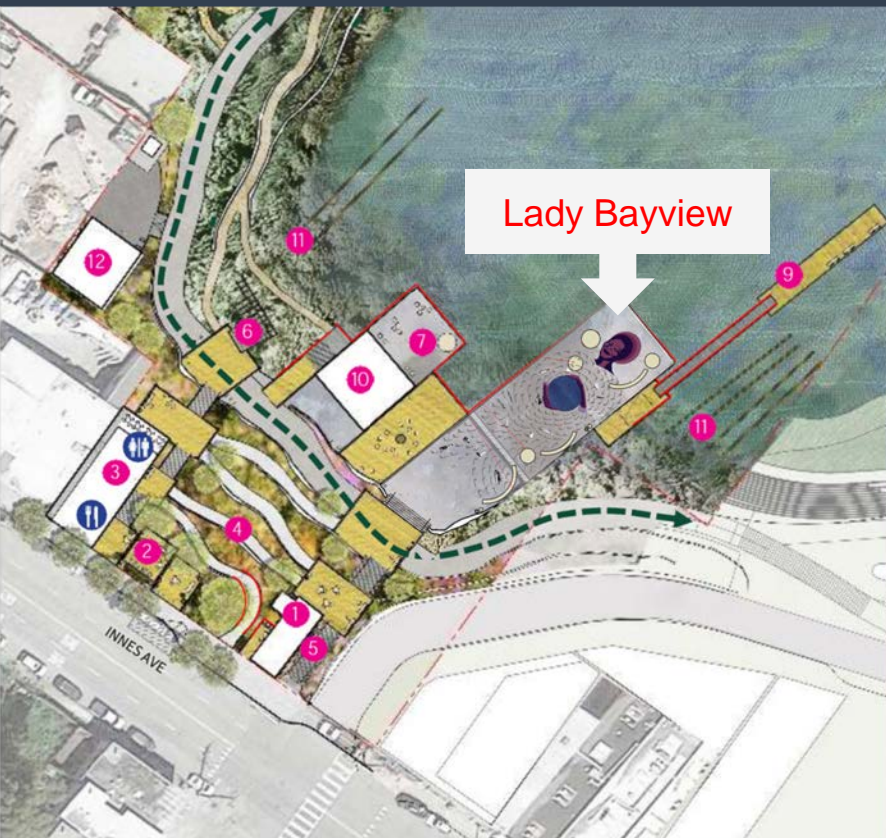

900 INNES (PHASES 1 & 2)



SHIPWRIGHT'S COTTAGE



FOOD PAVILION



MAKER / EVENT SPACE



KAYAK LAUNCH



SHORELINE PARK (PHASE 3)

PRIORITIES FOR PARK DEVELOPMENT

- Create inspiring and amenity-rich waterfront parks that build community capacity and are reflective of the Bayview community
- Address decades of environmental contamination from boat building and repair activities
- Create a resilient, healthy and adaptive shoreline and community



PROPOSED PROGRAMMING



Art &
Culture
Spaces



Community
Spaces



Food
Pavilion



Fitness
Stations



Picnic Areas



Playgrounds



Sports &
Play Areas



Shoreline
Access



Boating &
Fishing



Wildlife
Habitat

BEFORE: 900 INNES BOATYARD PARK



AFTER: SHORELINE PARK



PHASING/SCHEDULE

➤ PHASE 1: REMEDIATION

Completed August 2022

➤ PHASE 2: 900 INNES PARK

September 2022 – April 2024

➤ PHASE 3: SHORELINE PARK

July 2024 – July 2026



Why an EDP is critical to this project's success



Addresses social, economic and environmental issues in a historically underserved neighborhood



Ensures that we are mindful of equitable park investments and are actively working to prevent green displacement



What is green displacement?

When large parks are built in historically marginalized urban areas, they can contribute to a process involving increases in housing prices and the influx of new, wealthier and often white residents, displacing existing low-income communities of color

EDP LEADERSHIP COMMITTEE

- 34 meetings since October 2019
- Tasked with facilitating community-drafted plan and roadmap
- Local leaders with experience in economic and community development
- Provide feedback and direction on the Plan as well as the design of the Parks



EDP GOALS

- Support the development of the India Basin Waterfront Parks designed in partnership with the Bayview-Hunters Point community
- Prevent further displacement of the Black community living and working in Bayview-Hunters Point
- Acknowledge and correct historic and systemic environmental injustices within Bayview-Hunters Point
- Provide sustained resources that support and guide ongoing community organizing, capacity-building, and decision-making efforts within the area
- Leverage the Park as a catalyst for environmental remediation and regeneration

EDP AREAS OF FOCUS





Arts, Culture & Identity

STRATEGY 1

Ensure park programming is equitable and responsive to community needs and desires

STRATEGY 2

Design the park to preserve and celebrate Black culture and the neighborhood's cultural diversity



INITIATIVE BUDGET & SOURCES

INDIA BASIN WATERFRONT PARK PROJECTED BUDGET \$150,000,000

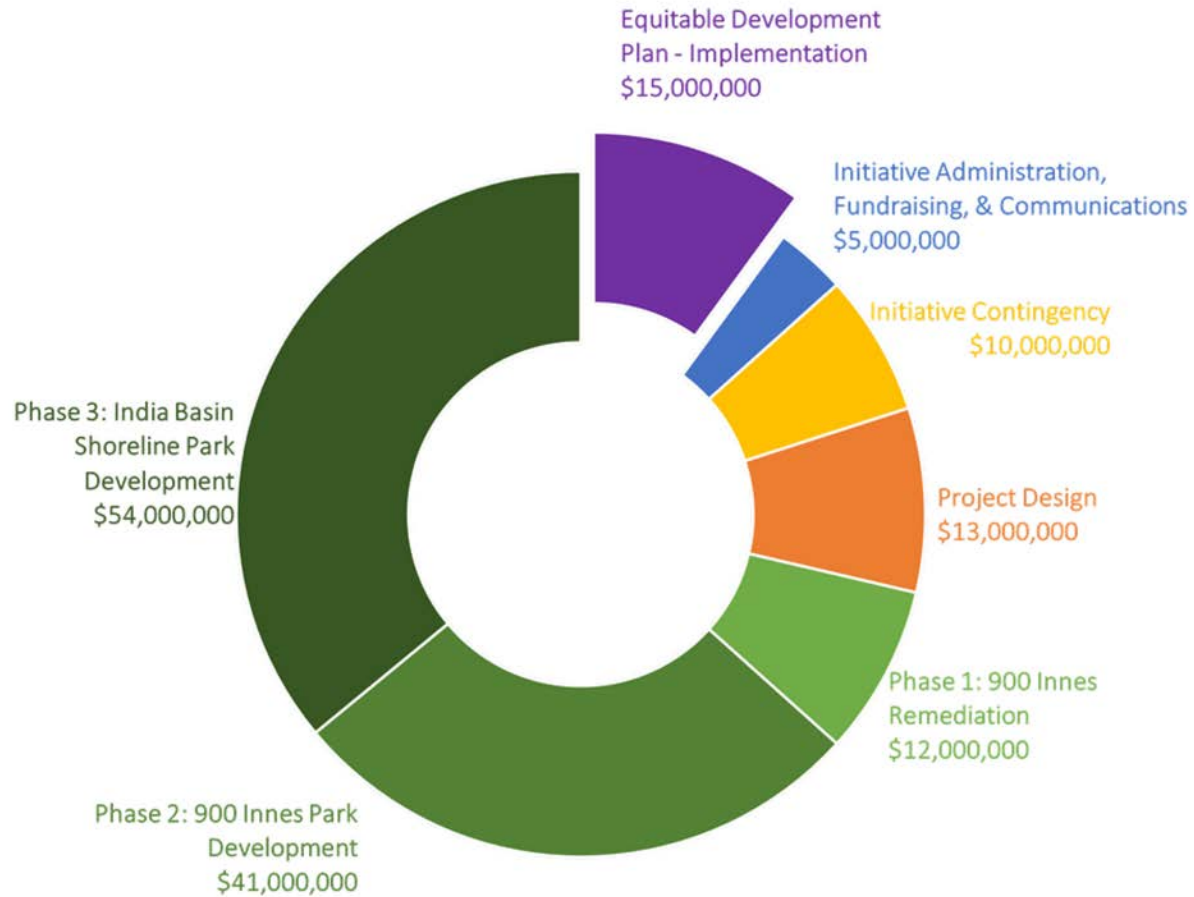

FUNDING SECURED AS OF JANUARY 2022 \$108,280,978

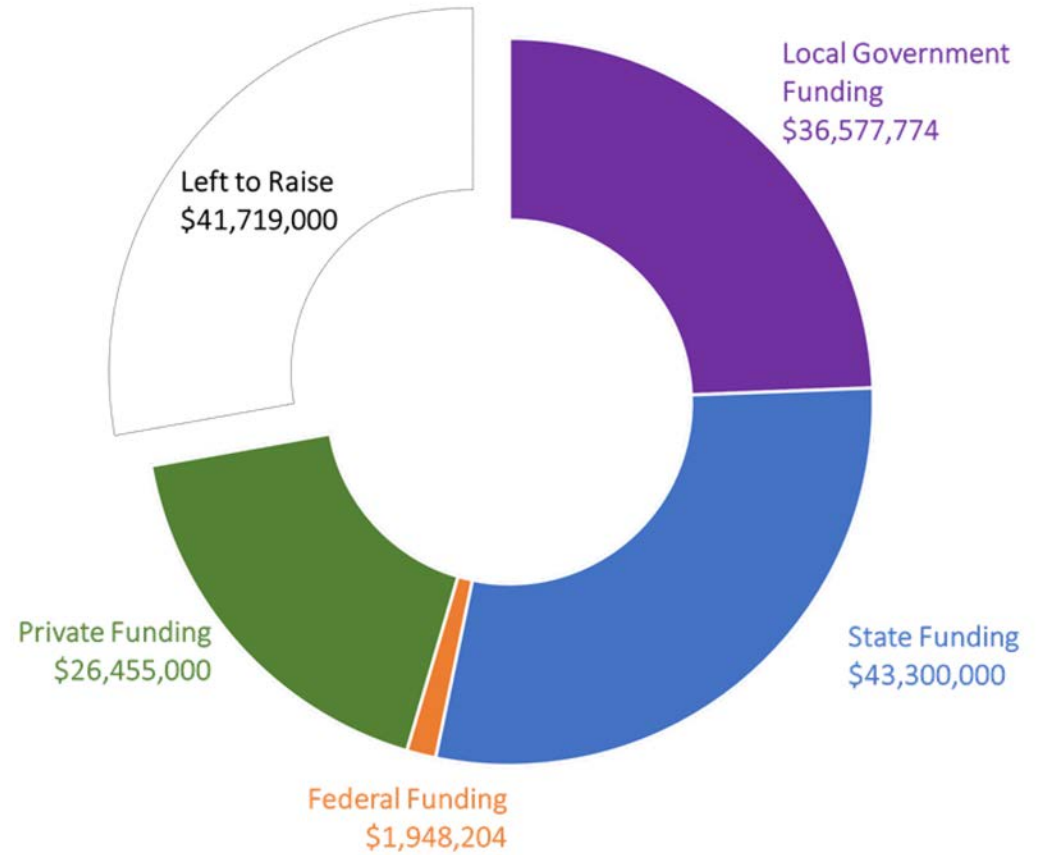

INTER-AGENCY COLLABORATION



- EIR Certification
- Preservation Planning staff support with Historic Preservation Commission, mitigation measure compliance efforts



- Development Agreement with BUILD Inc
- Workforce Development Plan and Framework



- Supported original Brownfields investigations for Shipwright's Cottage and project site



- Environmental Planning Staff review of MOUs, permits, providing expertise as we co-permit park spaces



- Robust arts enrichment process
- Engagement with EDP Leadership
- Partnership in vision plan for arts and culture on-site



- Site Assessment Remediation Division
- Contract on HazMat Administration (Bidding & Award)
- Construction Management Services
- BSM Street Vacation



- Pre-application engagement & intake
- Permitting and plan check and efforts to help establish new processes



- Transportation Plans
- Quick Build Improvements



- Pre-app electrical service coordination
- Wastewater Enterprise efforts to facilitate decommissioning of CSO



India Basin Shoreline Park Project Background

In 2014, the San Francisco Recreation and Park Department (SFRPD) acquired 900 Innes at India Basin in San Francisco's Bayview-Hunters Point (BVHP) neighborhood. With scenic views, waterfront access, and natural resources, the site is the Department's only San Francisco Bay-front property.

The proposed plan combines the existing India Basin Shoreline Park area and 900 Innes property into one 10-acre waterfront park development that closes a critical gap in the San Francisco Bay Trail. 900 Innes served as the first phase of the project, while the development for the rest of the India Basin Shoreline Park follows in this second phase. **Commissioned artwork design of the 900 Innes Pier 2 by artist Raylene Gorum was selected for the site in in Spring 2021.**

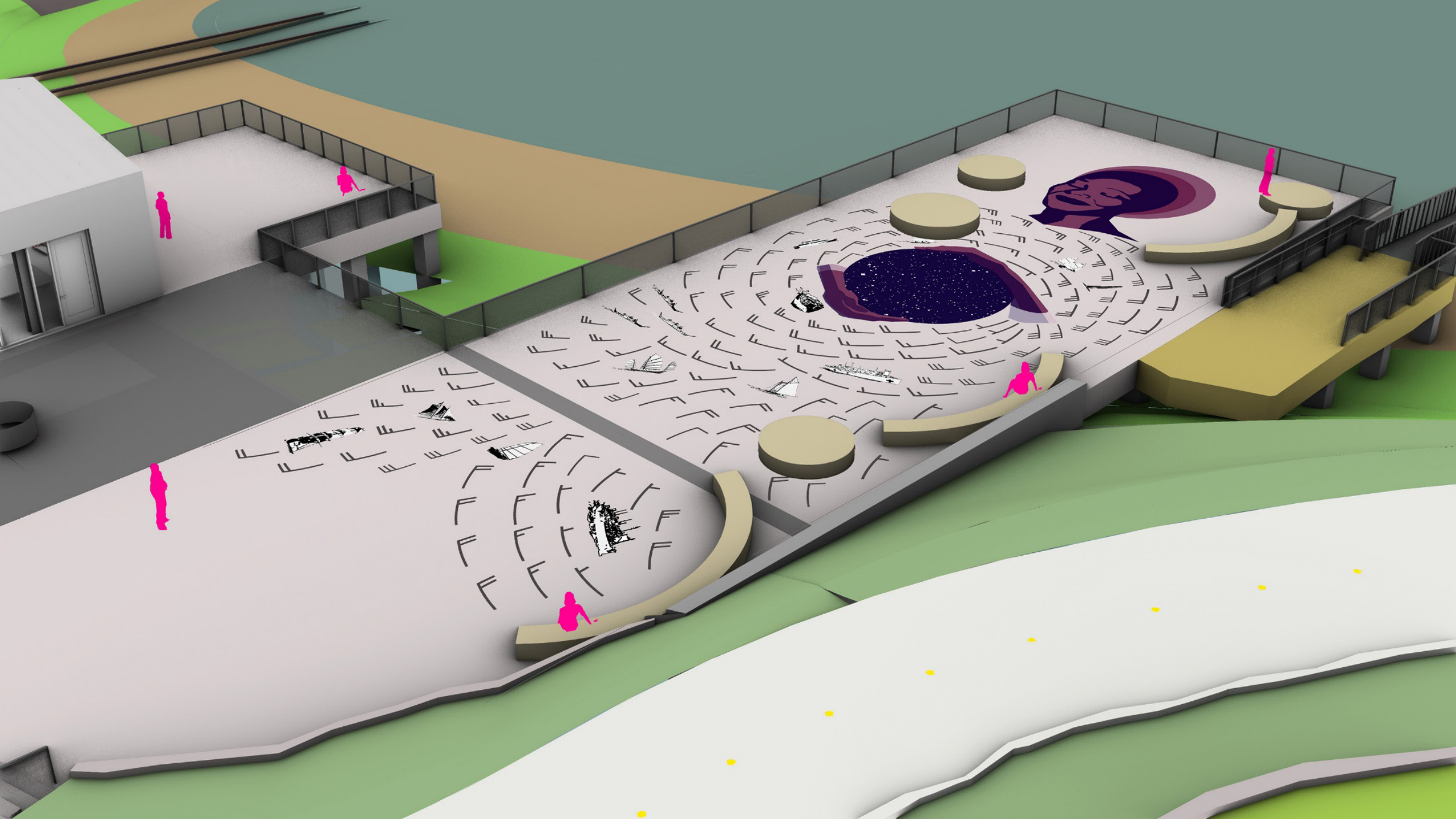

An aerial rendering of the India Basin Shoreline Park. The image shows a waterfront area with a paved walking path, benches, trees, and a playground. In the background, there are industrial cranes and a building. A dark blue rectangular overlay is positioned in the center, containing white text and a list of bullet points.

India Basin Shoreline Park Art Enrichment Opportunity

- The Arts Commission is looking to commission a sculpture or series of human-scale sculptures located along the walking paths through the India Basin Shoreline Park.
- Artwork must consist of durable, sustainable materials intended for exterior use.

An aerial rendering of a park project. In the background, three large cranes stand on a pier overlooking a body of water. The park features a paved walkway, benches, trees, and landscaped areas with various plants. People are shown walking, sitting on benches, and playing on a colorful court. The sky is blue with some clouds.

Project Goals

- Be inspired by and responsive to both the site and the proposed park design, including its natural habitats, physical landscape, site history, sustainability, and program.
- Be a point of discovery and have a cohesive narrative experience along trails of the park
- Serve as an asset for the community and expression of neighborhood identity.
- Provide a community benefit, which includes providing opportunities for artists with a meaningful connection to the Bayview.

An aerial rendering of a waterfront park. In the background, there are three large blue cranes on a pier extending into the water. The park features a paved walkway, a playground with colorful equipment, a picnic area with tables and benches, and various trees and landscaping. People are shown walking and sitting on benches, suggesting a lively public space.

Budget

- Artwork Budget: \$212,300, inclusive of all artist fees, as well as associated expenses for artwork design, fabrication, insurance, transportation, and consultation during installation.
- Estimated Site Costs and Installation: \$75,000 (managed by SFAC)



Artist Selection Process

Artist Qualification Panel: The applications will be reviewed by an Artist Qualification Panel to identify a list of the most qualified artists to be considered for the project opportunity.

Artist Review Panels: This list of the most qualified artists will be presented to an Artist Review Panel and they will identify finalists for recommendation to the Arts Commission for approval.

Finalists will be invited to develop conceptual proposals after attending an orientation session with the project team and key stakeholders. Each finalist will be paid an honorarium of \$2,500 for development of a conceptual design proposal. The proposals shall be displayed near the project site and posted on the Arts Commission website for written public comment prior to the final review panel meeting.

The Artist Review Panel will reconvene to consider the finalists' concepts in an interview format along with any community input and will recommend one artist for the project to the Arts Commission.

Arts Commission Approval: The Artist Review Panel's recommendation will be submitted first to the Visual Arts Committee (VAC), a subcommittee of the Arts Commission and then to the full Arts Commission for approval.

An aerial rendering of a waterfront park. In the background, there are three large cranes and a long pier extending into the water. The park features a paved walkway, a playground with colorful equipment, a picnic area with tables and benches, and various trees and landscaping. People are shown walking and sitting on benches, suggesting a lively public space.

Timeline

- **RFQ Deadline – Oct 14, 2022, 11:59 P.M. (PDT)**
- Qualification Panel Meeting – Late Oct 2022
- Review Panel Meeting 1 – Early Nov 2022
- Public Comment Period – Jan 2023
- Review Panel Meeting 2 – Feb 2023
- VAC approval of recommended artist – Feb 15, 2023
- Commission approval of artist – Mar 6, 2023
- Artist under contract – April 2023

*Dates subject to change



Community Involvement

- We ask the community to share the RFQ widely to artists that would be an appropriate fit for this call.
- A community representative will serve on the India Basin Shoreline Park Artist Review Panel and will participate in the Artist Orientation.
- The finalists' proposals will be on display for public comment near the project site and on the SFAC website for two weeks prior to the final review panel meeting. Community can provide feedback that will be shared to the panel.
- All review panels, Visual Arts Committee (VAC) and Commission meetings are open to the public. VAC and Commission Meetings welcome public comment.

An aerial rendering of a waterfront park. In the background, there are three large blue cranes and a building near a body of water. The park features a paved walking path, a colorful playground with a basketball court, a picnic table area, and various trees and landscaping. People are shown walking and sitting on benches.

How to Apply

Applications are available through SlideRoom, an online application system for calls for entry. There is no charge to artists for using SlideRoom. Please be sure to allow adequate time to submit your application as technical difficulties can occur. Applications that are mailed, emailed, faxed or hand-delivered will not be considered.

Application materials include:

1. Letter of Interest
2. Resume
3. Up to Ten images of previous work
4. Image Descriptions

Please note that Arts Commission staff will be available to answer questions about this call. Please contact Craig Corpora at craig.corpora@sfgov.org, or 415-252-2249

APPLICATIONS WILL NOT BE ACCEPTED AFTER THE OCTOBER 14, 2022, 11:59 P.M. (PDT) DEADLINE.



Thank you for attending!

If you have any additional questions regarding the India Basin Shoreline Park Public Art Project, you may contact:

Arianne Gelardin Davidian, Public Art Project Manager
at (415) 252 -2231 or Arianne.Davidian@sfgov.org

